



Rutherford County
Detention Center Expansion
Rutherfordton, North Carolina
Conceptual Estimate

Contact: Mike Kesterson
Date: 5/20/2025
Total SF: -

Rutherford County Detention Center - Renovation & Addition (Phase #1 and #2)				
WORK TRADE DESCRIPTION:	SF/ %:	COST/ SF:	SUBTOTAL:	TOTAL
1 RENOVATION & NEW CONSTRUCTION				\$ 7,968,674
PHASE 1 - PHASING, LOGISTICS, ENABLING	482.00	\$ 250.00	\$ 170,500	
PHASE 2A:				
NEW CONSTRUCTION	2,605.00	\$ 1,050.00	\$ 2,735,250	
RENOVATION	4,098.00	\$ 600.00	\$ 2,458,800	
PHASE 2B - RENOVATION	1,186.00	\$ 650.00	\$ 770,900	
CONCEPTUAL PLANNING			\$ 212,765	
DESIGN, ENGINEERING, PRECON, CA			\$ 822,850	
RECOMMENDED CONTINGENCIES:				
DESIGN/ ESTIMATE CONTINGENCY	5.0%		\$ 306,773	
TARIFF/ ESCALATION CONTINGENCY	8.0%		\$ 490,836	
2 ADD ALTERNATE #1 - EXISTING FLUSH VALVES				\$ 567,345
3 ADD ALTERNATE #2 - EXISTING EXHUAUST SHOWERS				\$ 212,298

The following Phasing Plan is preliminary and conceptual, it is subject to change based on final design, programming, logistics and life safety requirements.

RCDC Conceptual Phasing Plan - Phase 1 Enabling

482 SF

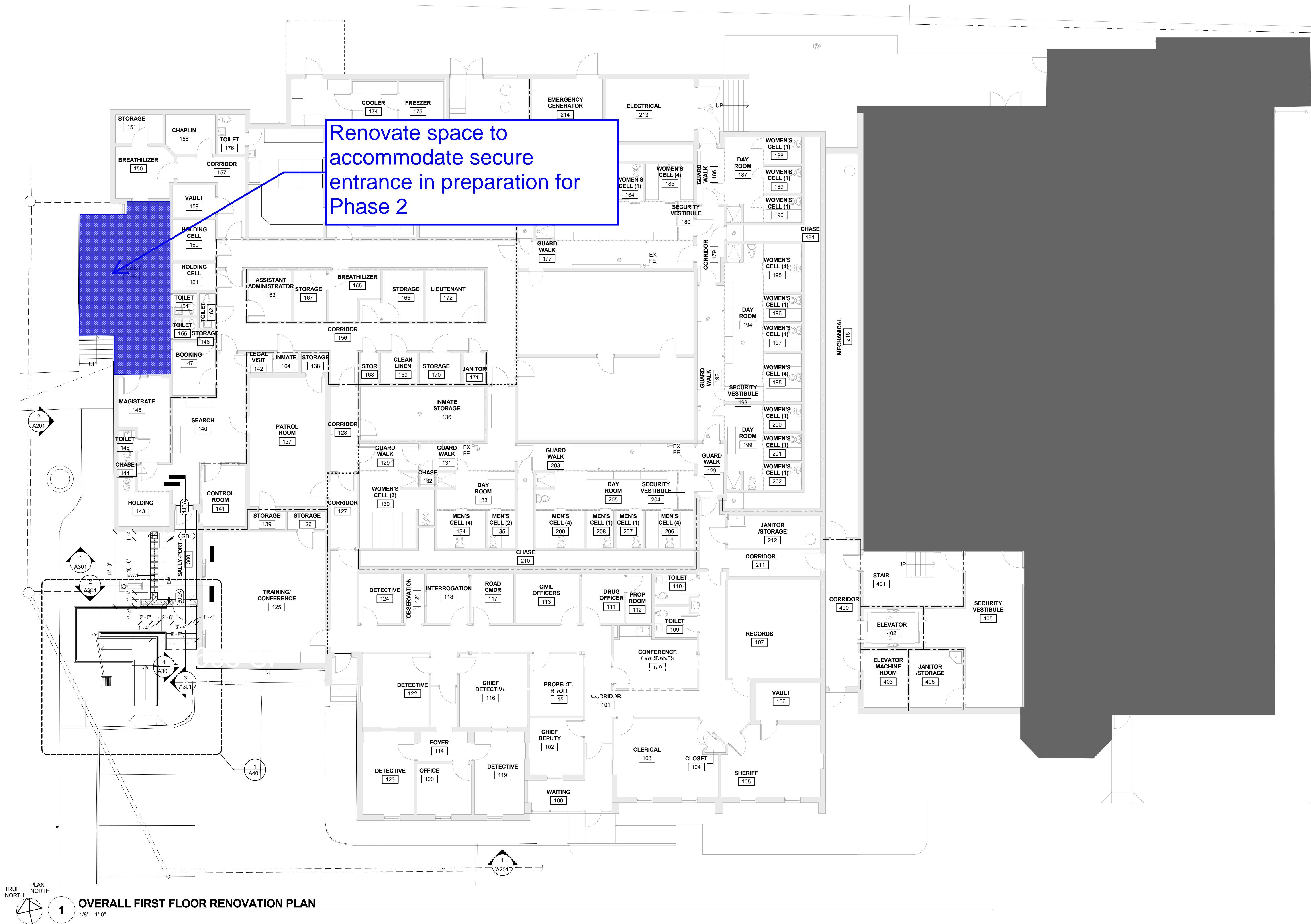





RCDC Conceptual Phasing Plan - Phase 2B

1186 SF



New secure Entrance will be open during this Phase

1 OVERALL FIRST FLOOR RENOVATION PLAN

$$1/8'' = 1'-0''$$